

**HOG SLAT
CATTLE SLAT
CHAIRS**

Exclusive design quickly and accurately positions both top and bottom rebars in a hog/cattle slat form. ONE STEP! They insure easy flow of concrete around them, thereby producing better castings, saving time and money. Spacers are made of high-quality, non-corrosive, non-staining, lightweight plastic.

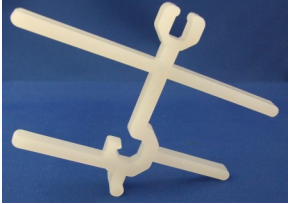

RIGHT SIDE UP CASTING



UPSIDE DOWN CASTING



PART NUMBER	DESCRIPTION	QTY PER BOX	BAR SIZE	COVER
6747490 (RIGHT-SIDE UP)	CATTLE / HOG SLAT	1,300	D = #3 E = #4	3/4" A = 3" B = 4" C = 5"
6747480 (RIGHT-SIDE UP)	CATTLE / HOG SLAT	1,050	D = #3 E = #4	3/4" A = 3" B = 5" C = 5"
6747390 (RIGHT-SIDE UP)	CATTLE / HOG SLAT		D = #3 E = #4	3/4" A = 4" B = 4" C = 6"
6747530 (RIGHT-SIDE UP)	CATTLE / HOG SLAT		D = #3 E = #4	3/4" A = 5" B = 4" C = 5"
6747430 (RIGHT-SIDE UP)	CATTLE / HOG SLAT		D = #3 E = #4	3/4" A = 5" B = 5" C = 7"
6747460 (UPSIDE DOWN)	CATTLE / HOG SLAT	1,400	D = #5 E = #5	3/4" A = 6" B = 4" C = 4"

**CATTLE SLAT
HOG SLAT**